

Cable Tie Mounts

Cable Tie Mounts

HellermannTyton offers a wide variety of mounting bases suited for many applications. Mounting bases are used in conjunction with cable ties to stabilize and secure wiring bundles, both indoors and outdoors. These mounting bases can be secured to a surface using rubber based adhesive, acrylic adhesive, or also can be screw mounted.

Cable Tie Mounting Bases

HellermannTyton's 4-way mounting bases are available in four sizes to accommodate T18 through T150 series cable ties. Insertion of ties can be made from all four sides. Each mount may be secured with two screws (four screws for the MB2.5 mount), with adhesive backing, or both, for ease of application and stability.

For applications where higher temperatures, certain chemicals, or UV radiation are a concern and an adhesive is the preferred method for securing, the acrylic adhesive 4-way mounting bases are recommended. The 2-way mounting bases may be secured with one screw, with adhesive backing, or both, and allow ties to be inserted from two sides.



Adhesive mounts are supplied in pairs connected together on an adhesive liner.

| Material Data | |
|-----------------------|--|
| Material | Polyamide 6.6 (PA66) |
| Operating Temperature | -40 °F to +185 °F (-40 °C to +85 °C) continuous |
| Flammability | UL94 V2 (excluding adhesive) |

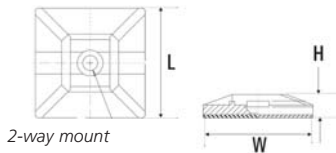

2-way mount

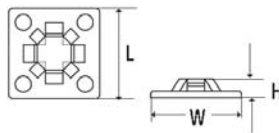

4-way, MB2.5 mount

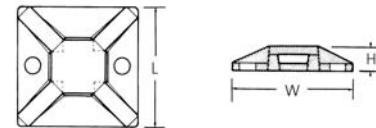

4-way, MB3, MB4 and MB5 mounts

Cable Tie Mounting Bases - Screw Mount

CTUS
File# E64139

| Product Selection | | | | | Length (L) in. (mm) | Width (W) in. (mm) | Height (H) in. (mm) | Color | Pkg. Qty. |
|---------------------------|------------------|-------|------------------|-----------|------------------------|-----------------------|------------------------|-------|-----------|
| Article No. | Part No. | Type | Cable Tie Series | Mounting | | | | | |
| 2- Way Screw Mount | | | | | | | | | |
| 151-29104 | MB4SH10C2 | MB4SH | T18 - T50 | # 6 Screw | 1.115" (28.32) | 1.115" (28.32) | .202" (5.13) | White | 100 |
| 151-00323 | MB4SH10H4 | MB4SH | | | 1.115" (28.32) | 1.115" (28.32) | .202" (5.13) | White | 500 |
| 151-29100 | MB4SH0C2 | MB4SH | | | 1.115" (28.32) | 1.115" (28.32) | .202" (5.13) | Black | 100 |
| 151-29101 | MB4SH0H4 | MB4SH | | | 1.115" (28.32) | 1.115" (28.32) | .202" (5.13) | Black | 500 |
| 4- Way Screw Mount | | | | | | | | | |
| 151-28901 | MB2.510C2 | MB2.5 | T18 | # 3 Screw | .625" (15.88) | .625" (15.88) | .130" (3.3) | White | 100 |
| 151-28902 | MB2.510M4 | MB2.5 | | | .625" (15.88) | .625" (15.88) | .130" (3.3) | White | 1000 |
| 151-00285 | MB2.50C2 | MB2.5 | | | .625" (15.88) | .625" (15.88) | .130" (3.3) | Black | 100 |
| 151-00286 | MB2.50M4 | MB2.5 | | | .625" (15.88) | .625" (15.88) | .130" (3.3) | Black | 1000 |
| 151-28302 | MB310C2 | MB3 | T18, T30 | #4 Screw | .75" (19.0) | .75" (19.0) | .15" (3.8) | White | 100 |
| 151-28305 | MB310M4 | MB3 | | | .75" (19.0) | .75" (19.0) | .15" (3.8) | White | 1000 |
| 151-00136 | MB30C2 | MB3 | | | .75" (19.0) | .75" (19.0) | .15" (3.8) | Black | 100 |
| 151-28301 | MB30M4 | MB3 | | | .75" (19.0) | .75" (19.0) | .15" (3.8) | Black | 1000 |
| 151-28802 | MB410C2 | MB4 | T18 - T50 | #8 Screw | 1.12" (28.5) | 1.12" (28.5) | .19" (4.8) | White | 100 |
| 151-00319 | MB410H4 | MB4 | | | 1.12" (28.5) | 1.12" (28.5) | .19" (4.8) | White | 500 |
| 151-00320 | MB40C2 | MB4 | | | 1.12" (28.5) | 1.12" (28.5) | .19" (4.8) | Black | 100 |
| 151-28801 | MB40H4 | MB4 | | | 1.12" (28.5) | 1.12" (28.5) | .19" (4.8) | Black | 500 |
| 151-00324 | MB510C2 | MB5 | T18 - T150 | #8 Screw | 1.485" (37.7) | 1.485" (37.7) | .245" (6.2) | White | 100 |
| 151-28504 | MB510F4 | MB5 | | | 1.485" (37.7) | 1.485" (37.7) | .245" (6.2) | White | 250 |
| 151-28500 | MB50C2 | MB5 | | | 1.485" (37.7) | 1.485" (37.7) | .245" (6.2) | Black | 100 |
| 151-28501 | MB50F4 | MB5 | | | 1.485" (37.7) | 1.485" (37.7) | .245" (6.2) | Black | 250 |

Dimensions are approximate and subject to technical changes. Use **Part No.** for ordering and **Type** for specification purposes.

Cable Tie Mounting Bases *continued*

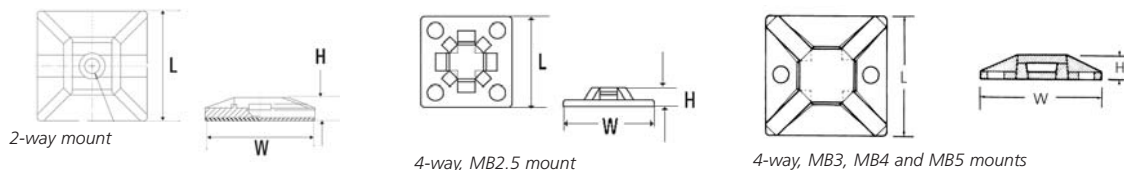

Cable Tie Mounting Bases - Rubber-Based Adhesive

CA US
File# E64139

| Product Selection | | | | | | | | | |
|--|------------|--------|------------------|----------|----------------|----------------|--------------|-------|-----------|
| Article No. | Part No. | Type | Cable Tie Series | Mounting | Length (L) | Width (W) | Height (H) | Color | Pkg. Qty. |
| | | | | | in. (mm) | in. (mm) | in. (mm) | | |
| 2- Way Mount with Rubber - Based Adhesive | | | | | | | | | |
| 151-29203 | MB4SHA10C2 | MB4SHA | T18 - T50 | Adhesive | 1.115" (28.32) | 1.115" (28.32) | .232" (5.89) | White | 100 |
| 151-29206 | MB4SHA10H4 | MB4SHA | | | 1.115" (28.32) | 1.115" (28.32) | .232" (5.89) | White | 500 |
| 151-29200 | MB4SHA0C2 | MB4SHA | | | 1.115" (28.32) | 1.115" (28.32) | .232" (5.89) | Black | 100 |
| 4- Way Mount with Rubber - Based Adhesive | | | | | | | | | |
| 151-29002 | MB2.5A10C2 | MB2.5A | T18 | Adhesive | .625" (15.88) | .625" (15.88) | .160" (4.1) | White | 100 |
| 151-00298 | MB2.5A10M4 | MB2.5A | | | .625" (15.88) | .625" (15.88) | .160" (4.1) | White | 1000 |
| 151-29000 | MB2.5A0C2 | MB2.5A | | | .625" (15.88) | .625" (15.88) | .160" (4.1) | Black | 100 |
| 151-29001 | MB2.5A0M4 | MB2.5A | | | .625" (15.88) | .625" (15.88) | .160" (4.1) | Black | 1000 |
| 151-28718 | MB3A10C2 | MB3A | T18, T30 | Adhesive | .75" (19.0) | .75" (19.0) | .18" (4.6) | White | 100 |
| 151-28721 | MB3A10M4 | MB3A | | | .75" (19.0) | .75" (19.0) | .18" (4.6) | White | 1000 |
| 151-28710 | MB3A0C2 | MB3A | | | .75" (19.0) | .75" (19.0) | .18" (4.6) | Black | 100 |
| 151-28713 | MB3A0M4 | MB3A | | | .75" (19.0) | .75" (19.0) | .18" (4.6) | Black | 1000 |
| 151-28421 | MB4A10C2 | MB4A | T18 - T50 | Adhesive | 1.12" (28.0) | 1.12" (28.0) | .22" (5.6) | White | 100 |
| 151-00321 | MB4A10H4 | MB4A | | | 1.12" (28.0) | 1.12" (28.0) | .22" (5.6) | White | 500 |
| 151-28403 | MB4A0C2 | MB4A | | | 1.12" (28.0) | 1.12" (28.0) | .22" (5.6) | Black | 100 |
| 151-28406 | MB4A0H4 | MB4A | | | 1.12" (28.0) | 1.12" (28.0) | .22" (5.6) | Black | 500 |
| 151-28529 | MB5A10C2 | MB5A | T18 - T150 | Adhesive | 1.485" (37.7) | 1.485" (37.7) | .275" (6.9) | White | 100 |
| 151-00427 | MB5A10F4 | MB5A | | | 1.485" (37.7) | 1.485" (37.7) | .275" (6.9) | White | 250 |
| 151-28602 | MB5A0C2 | MB5A | | | 1.485" (37.7) | 1.485" (37.7) | .275" (6.9) | Black | 100 |
| 151-28605 | MB5A0F4 | MB5A | | | 1.485" (37.7) | 1.485" (37.7) | .275" (6.9) | Black | 250 |

Dimensions are approximate and subject to technical changes. Use **Part No.** for ordering and **Type** for specification purposes.

Cable Tie Mounting Bases - Acrylic Adhesive

| Product Selection | | | | | | | | | |
|---|------------|------|------------------|----------|---------------|---------------|-------------|-------|-----------|
| Article No. | Part No. | Type | Cable Tie Series | Mounting | Length (L) | Width (W) | Height (H) | Color | Pkg. Qty. |
| | | | | | in. (mm) | in. (mm) | in. (mm) | | |
| 4 - Way Screw Mount Acrylic Adhesive | | | | | | | | | |
| 151-00331 | MB3A10A2C2 | MB3A | T18, T30 | Adhesive | .75" (19.0) | .75" (19.0) | .18" (4.6) | White | 100 |
| 151-28717 | MB3A10A2H4 | MB3A | | | .75" (19.0) | .75" (19.0) | .18" (4.6) | White | 500 |
| 151-28711 | MB3A0A2C2 | MB3A | | | .75" (19.0) | .75" (19.0) | .18" (4.6) | Black | 100 |
| 151-28709 | MB3A0A2H4 | MB3A | | | .75" (19.0) | .75" (19.0) | .18" (4.6) | Black | 500 |
| 151-28420 | MB4A10A2C2 | MB4A | T18 - T50 | Adhesive | 1.12" (28.5) | 1.12" (28.5) | .23" (5.9) | White | 100 |
| 151-00322 | MB4A10A2H4 | MB4A | | | 1.12" (28.5) | 1.12" (28.5) | .23" (5.9) | White | 500 |
| 151-28402 | MB4A0A2C2 | MB4A | | | 1.12" (28.5) | 1.12" (28.5) | .23" (5.9) | Black | 100 |
| 151-28405 | MB4A0A2H4 | MB4A | | | 1.12" (28.5) | 1.12" (28.5) | .23" (5.9) | Black | 500 |
| 151-28607 | MB5A10A2C2 | MB5A | T18 - T150 | Adhesive | 1.485" (37.7) | 1.485" (37.7) | .275" (6.9) | White | 100 |
| 151-28610 | MB5A10A2F4 | MB5A | | | 1.485" (37.7) | 1.485" (37.7) | .275" (6.9) | White | 250 |
| 151-28600 | MB5A0A2C2 | MB5A | | | 1.485" (37.7) | 1.485" (37.7) | .275" (6.9) | Black | 100 |
| 151-28604 | MB5A10A2F4 | MB5A | | | 1.485" (37.7) | 1.485" (37.7) | .275" (6.9) | Black | 250 |

Dimensions are approximate and subject to technical changes. Use **Part No.** for ordering and **Type** for specification purposes.

Cable Tie Mounts

Cable Tie Mounts

The CTM series is designed to provide stability to wire bundles. These mounts can accommodate miniature, intermediate, or standard cross-section cable ties. Each mount is secured with a single screw.



| Material Data | |
|-----------------------|--|
| Material | Polyamide 6.6 (PA66) |
| Operating Temperature | -40 °F to +185 °F (-40 °C to +85 °C) continuous |
| Flammability | UL94 V2 |

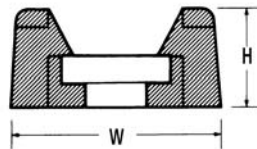
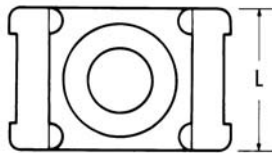

UL
File# E64139

| Product Selection | | | | | | | | | | | | | |
|-------------------|-----------------|------|------------------|------------|------------|---------|-----------|--------|------------|--------|--------|-----------|------|
| Article No. | Part No. | Type | Cable Tie Series | Mounting | Length (L) | | Width (W) | | Height (H) | | | | |
| | | | | | in. | (mm) | in. | (mm) | in. | (mm) | Color | Pkg. Qty. | |
| 151-30303 | CTM010C2 | CTM0 | T18 - T50 | # 6 Screw | .578" | (14.68) | .375" | (9.52) | .266" | (6.76) | White | 100 | |
| 151-30305 | CTM010M4 | | | | .578" | (14.68) | .375" | (9.52) | .266" | (6.76) | White | 1000 | |
| 151-30300 | CTM00C2 | | | | .578" | (14.68) | .375" | (9.52) | .266" | (6.76) | Black | 100 | |
| 151-30301 | CTM00M4 | | | | .578" | (14.68) | .375" | (9.52) | .266" | (6.76) | Black | 1000 | |
| 151-30404 | CTM110C2 | CTM1 | | T18 - T50 | # 8 Screw | .579" | (14.71) | .370" | (9.40) | .266" | (6.76) | White | 100 |
| 151-30406 | CTM110M4 | | | | | .579" | (14.71) | .370" | (9.40) | .266" | (6.76) | White | 1000 |
| 151-30400 | CTM10C2 | | | | | .579" | (14.71) | .370" | (9.40) | .266" | (6.76) | Black | 100 |
| 151-30402 | CTM10M4 | | | | | .579" | (14.71) | .370" | (9.40) | .266" | (6.76) | Black | 1000 |
| 151-30504 | CTM210C2 | CTM2 | T18 - T50 | | # 8 Screw | .857" | (21.77) | .605" | (15.37) | .372" | (9.45) | White | 100 |
| 151-30506 | CTM210M4 | | | | | .857" | (21.77) | .605" | (15.37) | .372" | (9.45) | White | 1000 |
| 151-30500 | CTM20C2 | | | | | .857" | (21.77) | .605" | (15.37) | .372" | (9.45) | Black | 100 |
| 151-30501 | CTM20M4 | | | | | .857" | (21.77) | .605" | (15.37) | .372" | (9.45) | Black | 1000 |
| 151-30605 | CTM310C2 | CTM3 | | T18 - T120 | #10 Screw | .858" | (21.79) | .609" | (15.47) | .374" | (9.50) | White | 100 |
| 151-30607 | CTM310M4 | | | | | .858" | (21.79) | .609" | (15.47) | .374" | (9.50) | White | 1000 |
| 151-30600 | CTM30C2 | | | | | .858" | (21.79) | .609" | (15.47) | .374" | (9.50) | Black | 100 |
| 151-30603 | CTM30M4 | | | | | .858" | (21.79) | .609" | (15.47) | .374" | (9.50) | Black | 1000 |
| 151-30703 | CTM410C2 | CTM4 | T18 - T120 | | .25" Screw | .864" | (21.95) | .616" | (15.65) | .372" | (9.45) | White | 100 |
| 151-30705 | CTM410M4 | | | | | .864" | (21.95) | .616" | (15.65) | .372" | (9.45) | White | 1000 |
| 151-30700 | CTM40C2 | | | | | .864" | (21.95) | .616" | (15.65) | .372" | (9.45) | Black | 100 |
| 151-30702 | CTM40M4 | | | | | .864" | (21.95) | .616" | (15.65) | .372" | (9.45) | Black | 1000 |

Dimensions are approximate and subject to technical changes. Use **Part No.** for ordering and **Type** for specification purposes.

Low Profile Cable Tie Mounts

Low profile mounts are intended for use in securing bundles where space is limited. Each mount is fastened with a single screw.



| Material Data | |
|-----------------------|--|
| Material | Polyamide 6.6 (PA66) |
| Operating Temperature | -40 °F to +185 °F (-40 °C to +85 °C) continuous |
| Flammability | UL94 V2 |

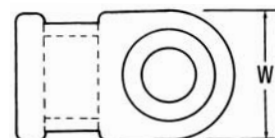
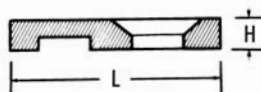

UL US
File# E64139

| Product Selection | | | | | | | | | |
|-------------------|---------------|------|------------------|-----------|---------------|---------------|--------------|---------|-----------|
| Article No. | Part No. | Type | Cable Tie Series | Mounting | Length (L) | Width (W) | Height (H) | Color | Pkg. Qty. |
| | | | | | in. (mm) | in. (mm) | in. (mm) | | |
| 151-00226 | MB19C2 | MB1 | T18 | #2 Screw | .500" (12.70) | .312" (7.92) | .130" (3.30) | Natural | 100 |
| 151-00294 | MB19M4 | | | | .500" (12.70) | .312" (7.92) | .130" (3.30) | Natural | 1000 |
| 151-00295 | MB10C2 | | | | .500" (12.70) | .312" (7.92) | .130" (3.30) | Black | 100 |
| 151-00296 | MB10M4 | | | | .500" (12.70) | .312" (7.92) | .130" (3.30) | Black | 1000 |
| 151-00227 | MB29C2 | MB2 | T18 - T50 | # 8 Screw | .807" (20.50) | .490" (12.45) | .130" (3.30) | Natural | 100 |
| 151-00297 | MB29M4 | | | | .807" (20.50) | .490" (12.45) | .130" (3.30) | Natural | 1000 |
| 151-28210 | MB20C2 | | | | .807" (20.50) | .490" (12.45) | .130" (3.30) | Black | 100 |
| 151-28202 | MB20M4 | | | | .807" (20.50) | .490" (12.45) | .130" (3.30) | Black | 1000 |

Dimensions are approximate and subject to technical changes. Use **Part No.** for ordering and **Type** for specification purposes.

Low Profile Rivet Mounts

The low profile rivet mount is designed to secure wiring bundles and fastens with the drive rivet through a predrilled hole. This mount is ideal for use in applications where space is limited.



| Material Data | |
|-----------------------|--|
| Material | Polyamide 6.6 (PA66) |
| Operating Temperature | -40 °F to +185 °F (-40 °C to +85 °C) continuous |
| Flammability | UL94 V2 |

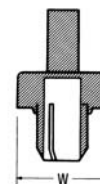
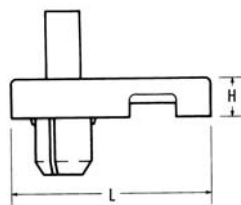

| Product Selection | | | | | | | | | | |
|-------------------|------------------|--------|------------------|-----------------|----------------------|---------------|---------------|--------------|---------|-----------|
| Article No. | Part No. | Type | Cable Tie Series | Mounting Hole Ø | Max. Panel Thickness | Length (L) | Width (W) | Height (H) | Color | Pkg. Qty. |
| | | | | in. (mm) | in. (mm) | in. (mm) | in. (mm) | in. (mm) | | |
| 151-27000 | LKCRF19C2 | LKCRF1 | T18 - | .250" (6.35) | .134" (3.4) | .938" (23.82) | .470" (11.94) | .157" (3.99) | Natural | 100 |
| 151-27009 | LKCRF19H4 | LKCRF1 | T50 | .250" (6.35) | .134" (3.4) | .938" (23.82) | .470" (11.91) | .157" (3.99) | Natural | 500 |

Dimensions are approximate and subject to technical changes. Use **Part No.** for ordering and **Type** for specification purposes.

Cable Tie Mounts

Push Mounts

Intended for use in a predrilled hole, this push mount accepts T18 through T50 series cable ties. Once inserted through the hole, the mount locks into place.

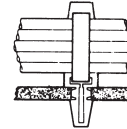
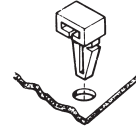
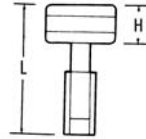

| Material Data | |
|-----------------------|--|
| Material | Polyamide 6.6 (PA66) |
| Operating Temperature | -40 °F to +185 °F (-40 °C to +85 °C) continuous |
| Flammability | UL94 V2 |



US
File# E64139

Product Selection

| Article No. | Part No. | Type | Cable Tie Series | Mounting Hole Ø | Max. Panel Thickness | Length (L) | Width (W) | Height (H) | Color | Pkg. Qty. |
|-------------|------------------|-------|------------------|-----------------|----------------------|---------------|---------------|--------------|-------|-----------|
| | | | | in. (mm) | in. (mm) | in. (mm) | in. (mm) | in. (mm) | | |
| 151-40106 | TM1SF10C2 | TM1SF | T18 - T50 | .25" (6.3) | .134" (3.4) | .616" (15.65) | .401" (10.19) | .181" (4.60) | White | 100 |
| 151-00328 | TM1SF10M4 | TM1SF | | .25" (6.3) | .134" (3.4) | .616" (15.65) | .401" (10.19) | .181" (4.60) | White | 1000 |
| 151-40100 | TM1SF0C2 | TM1SF | | .25" (6.3) | .134" (3.4) | .616" (15.65) | .401" (10.19) | .181" (4.60) | Black | 100 |
| 151-40101 | TM1SF0M4 | TM1SF | | .25" (6.3) | .134" (3.4) | .616" (15.65) | .401" (10.19) | .181" (4.60) | Black | 1000 |

Dimensions are approximate and subject to technical changes. Use **Part No.** for ordering and **Type** for specification purposes.

Push Button Mounts

The push button mounts are used where the back of the panel is accessible.

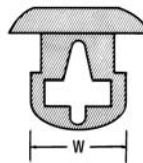
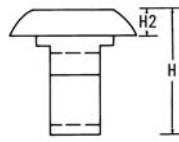

| Material Data | |
|-----------------------|--|
| Material | Polyamide 6.6 (PA66) |
| Operating Temperature | -40 °F to +185 °F (-40 °C to +85 °C) continuous |
| Flammability | UL94 V2 |



US
File# E64139

Product Selection

| Article No. | Part No. | Type | Cable Tie Series | Mounting Hole Ø | Max. Panel Thickness | Width (W) | Height (H) | Height (H2) | Color | Pkg. Qty. |
|-------------|----------------|------|------------------|-----------------|----------------------|-------------|--------------|-------------|-------|-----------|
| | | | | in. (mm) | in. (mm) | in. (mm) | in. (mm) | in. (mm) | | |
| 151-00230 | PBM10C2 | PBM | T18 - T50 | .25" (6.4) | .122" (3.1) | .26" (6.60) | .40" (10.16) | .08" (2.03) | White | 100 |
| 151-00231 | PBM10M4 | PBM | | .25" (6.4) | .122" (3.1) | .26" (6.60) | .40" (10.16) | .08" (2.03) | White | 1000 |
| 151-00228 | PBM0C2 | PBM | | .25" (6.4) | .122" (3.1) | .26" (6.60) | .40" (10.16) | .08" (2.03) | Black | 100 |
| 151-00229 | PBM0M4 | PBM | | .25" (6.4) | .122" (3.1) | .26" (6.60) | .40" (10.16) | .08" (2.03) | Black | 1000 |

Dimensions are approximate and subject to technical changes. Use **Part No.** for ordering and **Type** for specification purposes.

Cable Tie Anchor Mounts

Cable ties may be inserted from any of the four sides of the CTAM. This feature allows the mount to be placed either parallel or perpendicular to the wires.

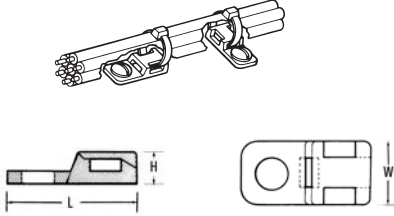

| Material Data | |
|-----------------------|--|
| Material | Polyamide 6.6 (PA66) |
| Operating Temperature | -40 °F to +185 °F (-40 °C to +85 °C) continuous |
| Flammability | UL94 V2 |



| Product Selection | | | | | | | | | |
|-------------------|------------------|-------|------------------|-----------|---------------|---------------|--------------|-------|-----------|
| Article No. | Part No. | Type | Cable Tie Series | Mounting | Width (W) | Length (L) | Height (H) | Color | Pkg. Qty. |
| | | | | | in. (mm) | in. (mm) | in. (mm) | | |
| 151-31103 | CTAM110C2 | CTAM1 | T18 - T50 | #8 screw | .400" (10.16) | .800" (20.32) | .200" (5.08) | White | 100 |
| 151-31106 | CTAM110M4 | CTAM1 | | | .400" (10.16) | .800" (20.32) | .200" (5.08) | White | 1000 |
| 151-31101 | CTAM10C2 | CTAM1 | | | .400" (10.16) | .800" (20.32) | .200" (5.08) | Black | 100 |
| 151-00287 | CTAM10M4 | CTAM1 | | | .400" (10.16) | .800" (20.32) | .200" (5.08) | Black | 1000 |
| 151-31203 | CTAM210C2 | CTAM2 | | #10 screw | .400" (10.16) | .800" (20.32) | .200" (5.08) | White | 100 |
| 151-31205 | CTAM210M4 | CTAM2 | | | .400" (10.16) | .800" (20.32) | .200" (5.08) | White | 1000 |
| 151-31201 | CTAM20C2 | CTAM2 | | | .400" (10.16) | .800" (20.32) | .200" (5.08) | Black | 100 |
| 151-31202 | CTAM20M4 | CTAM2 | | | .400" (10.16) | .800" (20.32) | .200" (5.08) | Black | 1000 |

Dimensions are approximate and subject to technical changes. Use **Part No.** for ordering and **Type** for specification purposes.

Cable Tie Anchor Plates

These plates have slotted mounting holes to provide for easier alignment of mount and bundles. Once aligned, they are fastened securely by tightening the applied screw. The CTAP2 allows an additional screw for maximum stability. Both plates are used perpendicularly to the wire bundle.

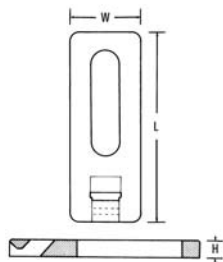

| Material Data | |
|-----------------------|--|
| Material | Polyamide 6.6 (PA66) |
| Operating Temperature | -40 °F to +185 °F (-40 °C to +85 °C) continuous |
| Flammability | UL94 V2 |



| Product Selection | | | | | | | | | |
|-------------------|------------------|-------|------------------|-----------|-------------|---------------|-------------|-------|-----------|
| Article No. | Part No. | Type | Cable Tie Series | Mounting | Width (W) | Length (L) | Height (H) | Color | Pkg. Qty. |
| | | | | | in. (mm) | in. (mm) | in. (mm) | | |
| 151-30100 | CTAP110C2 | CTAP1 | T18 - T50 | #10 screw | .50" (12.7) | 1.34" (34.04) | .15" (3.81) | White | 100 |
| 151-00288 | CTAP110M4 | CTAP1 | | | .50" (12.7) | 1.34" (34.04) | .15" (3.81) | White | 1000 |
| 151-00289 | CTAP10C2 | CTAP1 | | | .50" (12.7) | 1.34" (34.04) | .15" (3.81) | Black | 100 |
| 151-00290 | CTAP10M4 | CTAP1 | | | .50" (12.7) | 1.34" (34.04) | .15" (3.81) | Black | 1000 |
| 151-30200 | CTAP210C2 | CTAP2 | | | .50" (12.7) | 2.13" (54.1) | .14" (3.5) | White | 100 |
| 151-00308 | CTAP210H4 | CTAP2 | | | .50" (12.7) | 2.13" (54.1) | .14" (3.5) | White | 500 |
| 151-00291 | CTAP20C2 | CTAP2 | | | .50" (12.7) | 2.13" (54.1) | .14" (3.5) | Black | 100 |
| 151-00292 | CTAP20M4 | CTAP2 | | | .50" (12.7) | 2.13" (54.1) | .14" (3.5) | Black | 500 |

Dimensions are approximate and subject to technical changes. Use **Part No.** for ordering and **Type** for specification purposes.

Cable Tie Mounts

Lashing Tie Mounts

The lashing tie mount is designed to snap into the T250 lashing tie. The tie head is assembled perpendicular to the mount. The strap is parallel to the mount when inserted into the head. The lashing tie mount is recommended for indoor or outdoor wall mount cable applications.

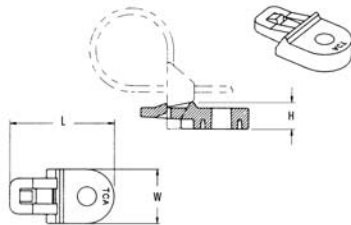

| Material Data | |
|-----------------------|--|
| Material | Polyamide 6.6 UV-resistant (PA66UV) |
| Operating Temperature | -40 °F to +185 °F (-40 °C to +85 °C) continuous |
| Flammability | UL94 V2 |



Product Selection

| Article No. | Part No. | Type | Cable Tie Series | Mounting | Width (W) | Length (L) | Height (H) | Color | Pkg. Qty. |
|-------------|------------------|--------|------------------|------------|---------------|---------------|--------------|-------|-----------|
| | | | | | in. (mm) | in. (mm) | in. (mm) | | |
| 151-00358 | LTM2500C2 | LTM250 | T250 | .25" screw | .733" (18.62) | 1.46" (37.08) | .378" (9.60) | Black | 100 |
| 151-00293 | LTM2500H4 | LTM250 | | | .733" (18.62) | 1.46" (37.08) | .378" (9.60) | | |

Dimensions are approximate and subject to technical changes. Use **Part No.** for ordering and **Type** for specification purposes.

Masonry Mounts

Masonry mounts provide a permanent method of attaching wire and cable to masonry surfaces. HellermannTyton's masonry mounts simply tap into predrilled holes and can be used for indoor and outdoor applications.

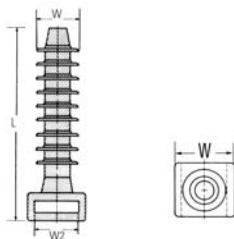

| Material Data | |
|-----------------------|--|
| Material | Polyamide 6.6 (PA66) |
| Operating Temperature | -40 °F to +185 °F (-40 °C to +85 °C) continuous |
| Flammability | UL94 V2 |



Product Selection

| Article No. | Part No. | Type | Cable Tie Series | Mounting Hole Ø | Min. Depth | Length (L) | Width (W) | Width (W2) | Width (W3) | Color | Pkg. Qty. |
|-------------|-----------------|-------|------------------|-----------------|----------------|----------------|--------------|--------------|--------------|-------|-----------|
| | | | | in. (mm) | in. (mm) | in. (mm) | in. (mm) | in. (mm) | in. (mm) | | |
| 151-29800 | MMB00C2 | MMB0 | T18 - T50 | .188" (4.7) | 1.0" (25.4) | 1.185" (30.1) | .355" (9.02) | .218" (5.54) | .236" (5.99) | Black | 100 |
| 151-00325 | MMB00M4 | MMB0 | | .188" (4.7) | | 1.185" (30.1) | .355" (9.02) | .218" (5.54) | .236" (5.99) | | |
| 151-00116 | MMB.50C2 | MMB.5 | | .25" (6.25) | | 1.244" (31.60) | .375" (9.53) | .220" (5.59) | .308" (7.82) | | |
| 151-30001 | MMB.50M4 | MMB.5 | | .25" (6.25) | 1.244" (31.60) | .375" (9.53) | .220" (5.59) | .308" (7.82) | | | |
| 151-00326 | MMB10C2 | MMB1 | | .312" (8.0) | 1.5" (38.10) | 1.71" (43.49) | .508" (12.9) | .374" (9.50) | .362" (9.19) | Black | 100 |
| 151-00327 | MMB10H4 | MMB1 | | .312" (8.0) | | 1.71" (43.49) | .508" (12.9) | .374" (9.50) | .362" (9.19) | | |

Dimensions are approximate and subject to technical changes. Use **Part No.** for ordering and **Type** for specification purposes.

Cable Tie Mounting Plates

Allowing multiple cables to be run in parallel, these mounting plates are secured with two screws. The cables are attached to the mounting plate by using a cable tie through any combination of the available slots.

| Material Data | |
|-----------------------|--|
| Material | Polyamide 6.6 (PA66) |
| Operating Temperature | -40 °F to +185 °F (-40 °C to +85 °C) continuous |
| Color | Natural |
| Flammability | UL94 V2 |

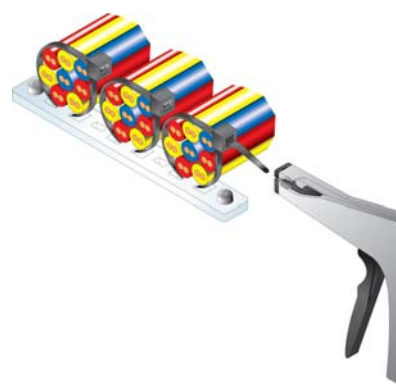
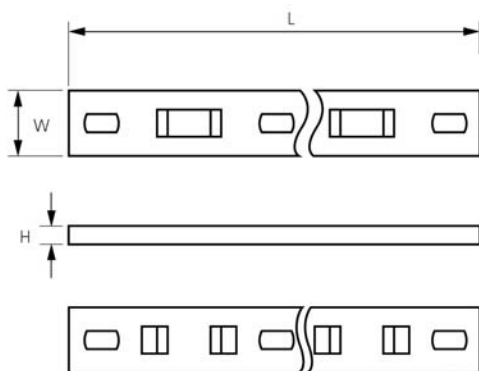
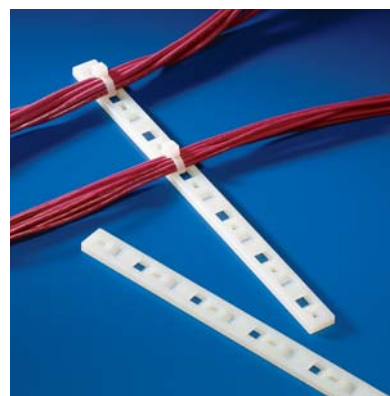

| Product Selection | | | Cable Tie Series | Mounting | Width (W) | | Length (L) | | Height (H) | | Pkg. Qty. |
|-------------------|--------------------|----------|------------------|----------------|-----------|--------|------------|---------|------------|--------|-----------|
| Article No. | Part No. | Type | | | in. | (mm) | in. | (mm) | in. | (mm) | |
| 154-00000 | MP1M3.NN3P | MP1M3 | T18 - T50 | # 6 (M3) screw | .50" | (12.7) | 1.75" | (44.4) | .125" | (3.2) | 100 |
| 154-00100 | MP1M5.NN3P | MP1M5 | | #10 (M5) screw | .50" | (12.7) | 1.75" | (44.4) | .125" | (3.2) | 100 |
| 151-24219 | MP2M3.NN3P | MP2M3 | | # 6 (M3) screw | .50" | (12.7) | 3.00" | (76.2) | .125" | (3.2) | 100 |
| 154-00300 | MP2M5.NN3P | MP2M5 | | #10 (M5) screw | .50" | (12.7) | 3.00" | (76.2) | .125" | (3.2) | 100 |
| 151-24319 | MP3M3.NN3P | MP3M3 | | # 6 (M3) screw | .50" | (12.7) | 4.25" | (108.0) | .125" | (3.2) | 100 |
| 154-00500 | MP3M5.NN3P | MP3M5 | | #10 (M5) screw | .50" | (12.7) | 4.25" | (108.0) | .125" | (3.2) | 100 |
| 151-24419 | MP4M3.NN3P | MP4M3 | | # 6 (M3) screw | .50" | (12.7) | 5.50" | (139.8) | .125" | (3.2) | 100 |
| 154-00700 | MP4M5.NN3P | MP4M5 | | #10 (M5) screw | .50" | (12.7) | 5.50" | (139.8) | .125" | (3.2) | 100 |
| 151-24519 | MP5M3.NN3P | MP5M3 | | # 6 (M3) screw | .50" | (12.7) | 6.75" | (171.6) | .125" | (3.2) | 100 |
| 154-00900 | MP5M5.NN3P | MP5M5 | | #10 (M5) screw | .50" | (12.7) | 6.75" | (171.6) | .125" | (3.2) | 100 |
| 154-00018 | MSMP5/69C2 | MSMP5/6 | | # 6 (M3) screw | .618" | (15.7) | 8.08" | (205.3) | .21" | (5.33) | 100 |
| 154-01200 | MSMP5/109C2 | MSMP5/10 | | #10 (M5) screw | .618" | (15.7) | 8.08" | (205.3) | .21" | (5.33) | 100 |
| 154-01302 | MSMP6/69C2 | MSMP6/7 | | # 6 (M3) screw | .618" | (15.7) | 9.58" | (243.3) | .21" | (5.33) | 100 |
| 154-01300 | MSMP6/109C2 | MSMP6/10 | | #10 (M5) screw | .618" | (15.7) | 9.58" | (243.3) | .21" | (5.33) | 100 |

Dimensions are approximate and subject to technical changes. Use **Part No.** for ordering and **Type** for specification purposes.